

## APPLICATIONS

### STRUCTURAL HEALTH MONITORING



### POLES AND LIGHTING: SMARTCITIES



### BUILDING INTEGRITY



**Our Mission:** Accelerating the world's transition to smart infrastructure

## CONTACT US

LiXiA  
Suite 2, 151-153 Hugh Street  
Currajong. Qld, 4812

[www.lixia.com.au](http://www.lixia.com.au)  
+61 7 4725 5874



**THE INTERNET OF  
INFRASTRUCTURE**



Revealing what's hidden

Lixia is a Townsville-based startup emerging from the CSIRO ON Program. We bring together deep expertise in infrastructure asset monitoring, computational engineering, IoT, AI and big data to revolutionise the maintenance of civil infrastructure.

## Data when it matters

The LiXiA IoT 'PUKs' (Pervasive, Ubiquitous Knowledge appliances) sense, process and transmit critical data to the LiXiA cloud.

Our cloud-based AI methods deliver asset owners essential, timely information to optimise safety, as well as CAPEX/OPEX expenditure and improved reliability.

## Easy install, long life

The LiXiA PUK is designed for simple, easy installation. Rugged industrial design and and robust sensors give years of trouble free high performance asset monitoring.

## PUKs, Clouds, Alerts

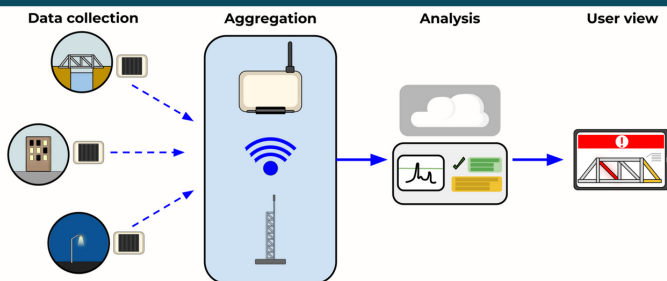

LiXiA PUKs measures key structural and environmental parameters:

**Acceleration**

**Tilt**

**Strain**

**Temperature**

**Humidity**

- Data is transmitted in near real time
- Edge processing and advanced Artificial Intelligence with physics
- Real time criticality alerts
- Advanced asset management
- Low-power / Long-life

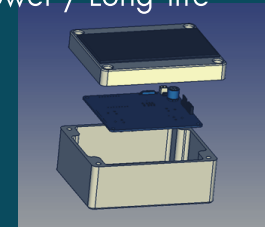

## Converting maintenance liabilities into data-generating assets

**LiXiA PUK**

**Pervasive Ubiquitous Knowledge appliance**

Sensors

Vibration/Tilt

Magnetometer

Temperature

Relative Humidity

Light (intensity)

Strain

Communications

LP-WAN networks

Bluetooth & 802.11 b/g/n networks